



## REPLACEMENT SPOOL AND CARTRIDGE INSTRUCTIONS

Use these instructions to replace your SRT-2® spools and cartridges.

**NOTICE TO INSTALLER:** Even if familiar with product, read instructions prior to installation as improvements may be made without notice. Always handle components with care. When done, these instructions must be given to the consumer.

**NOTICE TO CONSUMER:** Before using this product, read instructions. Save these instructions for future reference.

# PREPARATION

These instructions cover both replacement spool and replacement cartridge kits.

## TOOLS NEEDED

- Ratchet with 9/16" socket
- 9/16" Wrench
- Needle nose pliers
- Protective eyewear
- Marking pen
- 1/2" Deep well socket (cartridge only)
- 18" Long extension (cartridge only)
- Ft-lb Torque wrench (cartridge only)
- 1/2" Wrench (cartridge only)

**⚠ CAUTION:** Over torquing hardware may damage components.

**NOTE:** Hardware appearance and components may vary.

## PARTS DIAGRAM

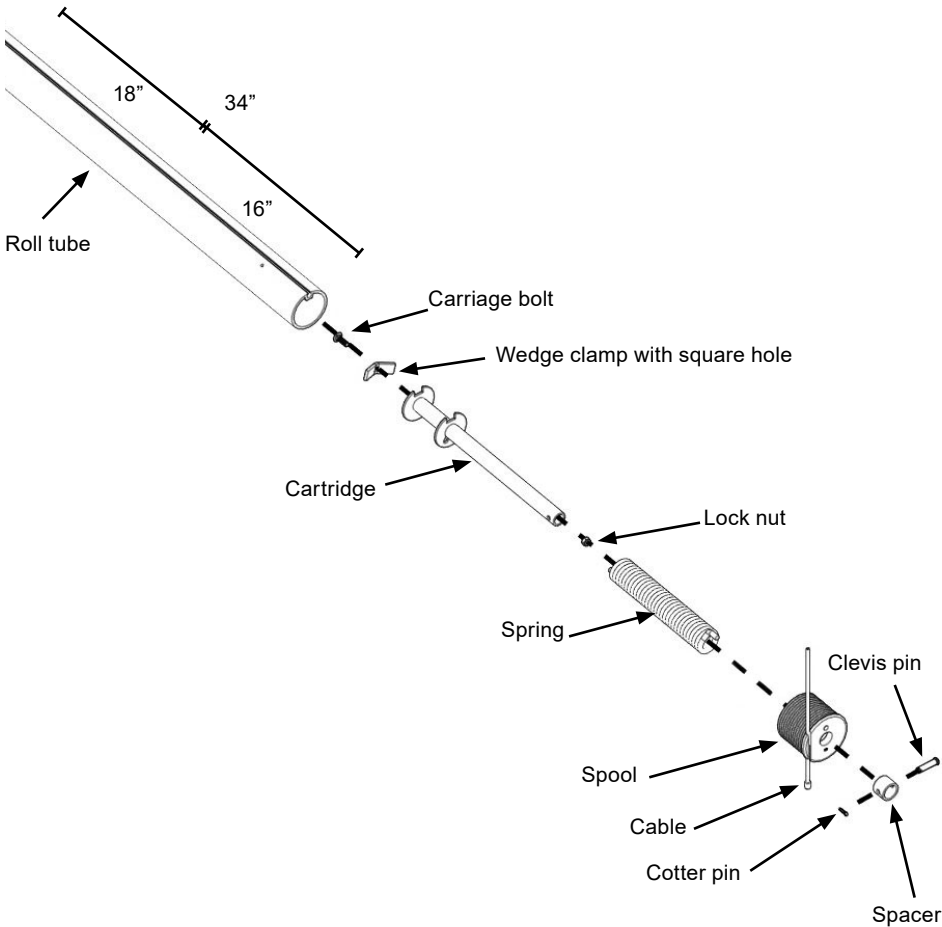

# 1: REMOVE EXISTING SPOOLS

**IMPORTANT:** For electric tarp, disconnect power source before removing motor.

A. Roll tarp to position with least amount of tension, release tension on ratchets and unwrap cable from existing spools.

B. Disconnect power source then electric motor from roll tube or crank handle from roll tube.

C. Remove cotter pin, clevis pin and spacer that secure spool. Remove spool and rubber ring (if present). Thoroughly clean outer area of roll tube where spool turns.

**NOTE:** Discard rubber ring if present.

**NOTE:** One spool is marked L (left) and the other spool is marked R (right). Ensure to replace existing spool with corresponding left or right replacement spool, if necessary.

D. Repeat Step 1C for opposite end.

**NOTE:** If only replacing spools, see Step 4.

# 2: REMOVE EXISTING CARTRIDGES

A. Record orientation of torsion spring and mark exposed tab end for reassembly, then remove spring.

B. Use long extension with 1/2" deep well socket to loosen existing bolt inside cartridge, then remove assembly.

### 3: INSTALL REPLACEMENT CARTRIDGES

A. Assemble wedge clamp to cartridge. Ensure wedge clamp is positioned as shown in parts diagram. Turn lock nut just tight enough to prevent carriage bolt from spinning.

B. Place cartridge assembly inside roll tube and adjust it to protrude out as shown. Torque lock nut to 20 ft-lbs.

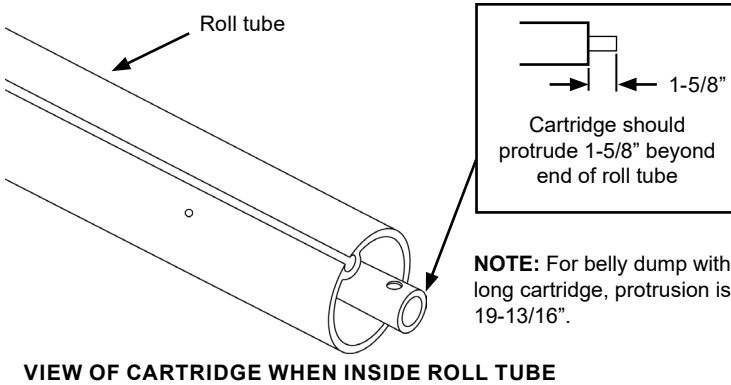

C. Insert spring (with end marked when removed in Step 2A) to outside.

D. Repeat Steps 2-3 for opposite end.

## 4: INSTALL REPLACEMENT SPOOLS

**NOTE:** Spool marked R (right) use with red marked spring and cartridge.

**IMPORTANT:** Do not use grease or lubricant on spools or tube.

**NOTE:** Ensure cartridge is centered in roll tube and spool is free to rotate. Adjust as needed.

A. Slide spool onto end of roll tube according to (L) or (R) marking.

- For left spool (L), turn spool counterclockwise about 1" while pushing until spring engages in roll tube and spring tab engages hole in spool.
- For right spool (R), turn spool clockwise about 1" while pushing until spring engages in roll tube and spring tab engages hole in spool.

B. On non-drive side, slide spacer on cartridge and secure with clevis and cotter pins, then bend cotter pin tabs.

**NOTE:** Non-drive side is opposite of tarp motor or crank handle.

C. On drive side, slide spacer on tube and perform one of the following:

- For manual tarp, insert clevis pin and secure with cotter pin at end of crank handle.
- For electric tarp, insert clevis pin and secure with cotter pin at end of motor extension.

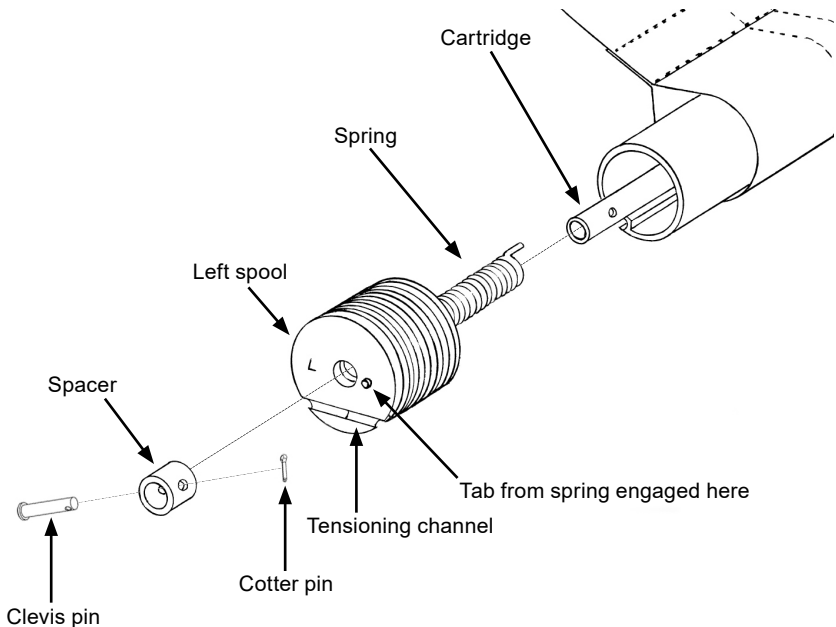

## 4: INSTALL REPLACEMENT SPOOLS (Continued)

D. Attach barrel end of cable to barrel groove on spool. Ensure cable follows grooves.

E. Wrap cable around spool grooves up to last full wrap with cable next to box wall, attach ball end of cable to hook on ratchet strap.

**IMPORTANT:** To prevent scratching or gouging, temporarily insert cardboard between box and ratchet hooks.

**TIP:** If cable doesn't reach bracket strap, unwrap cable one wrap. If unwrapping creates too much slack, turn ratchet bracket 180° as shown.

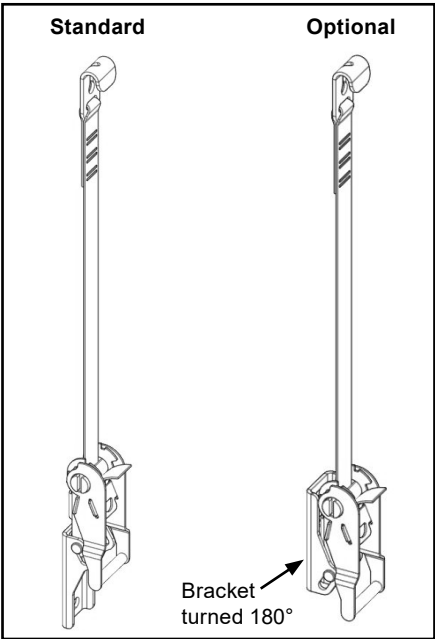

## 4: INSTALL REPLACEMENT SPOOLS (Continued)

F. Cable tension is easily determined by position of the tension channel on front and rear spools. As tension is applied with ratchet, spool turns. Watch the tensioning channel on side of spool. Proper tension is achieved when the tension channel is level at bottom.

**TIP:** Tighten ratchet an additional two clicks past level. Open and close tarp system, approximately five times to pull tarp snug. Tension channel should be level at bottom. Install crank handle or motor prior to opening and closing tarp system.

**IMPORTANT:** Periodically check tension level and always keep ratchet handle in locked down position during use.

**NOTE:** Remove cardboard once tension is set.

**TIP:** For best tarp performance, periodically clean both spool ends.

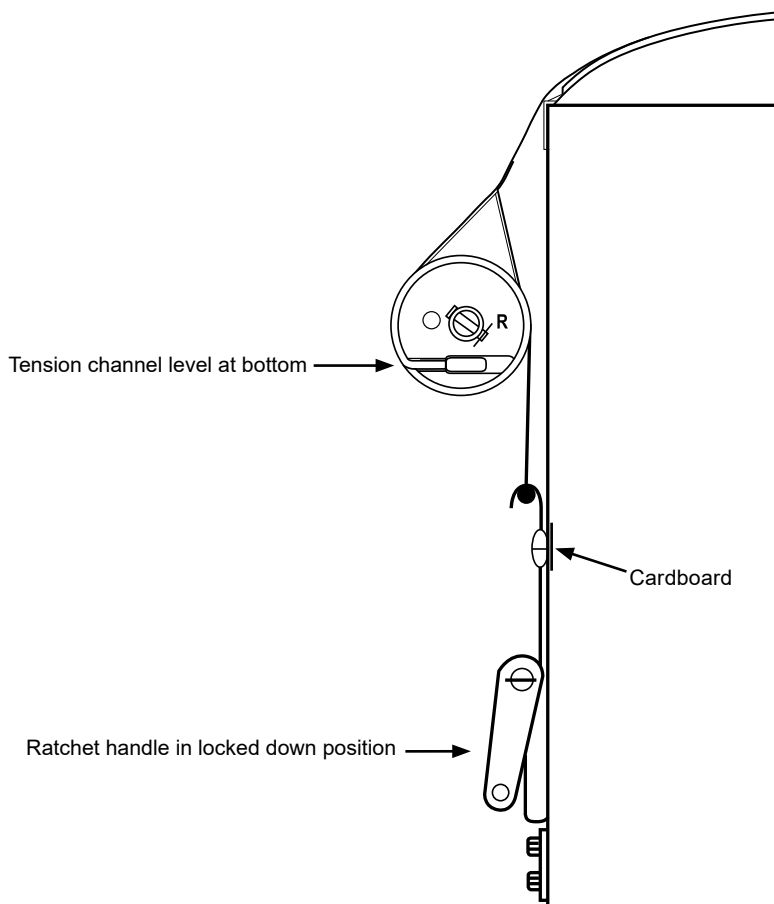

# 4: INSTALL REPLACEMENT SPOOLS (Continued)

**NOTE:** After tensioning spool to horizontal position and tarp has been cycled, if cable has excessive slack, tighten ratchet to apply additional tension up to 25° and cycle again. Repeat as needed.

